

# CATALOG NO. LPSC-69SK-HP-M20

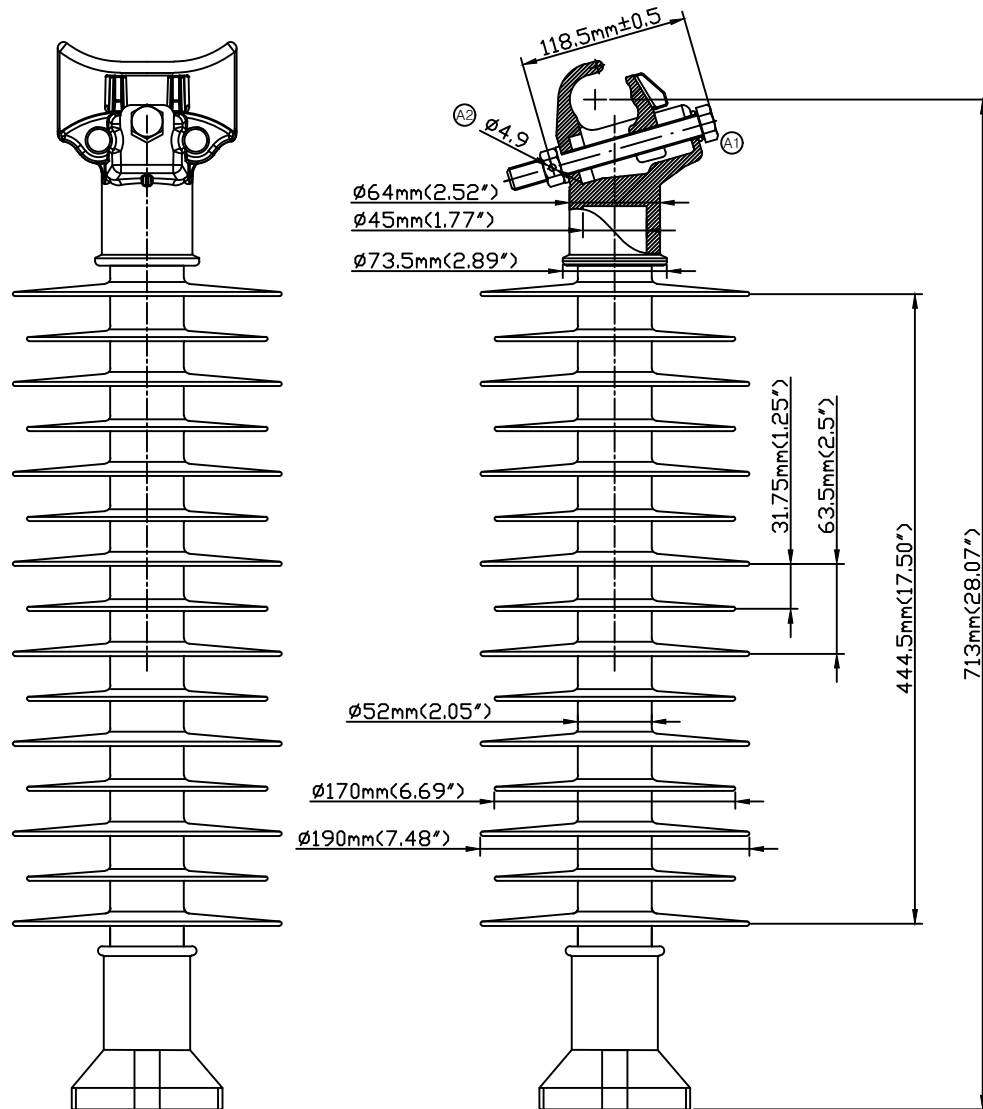

TAP : M20,  
PITCH : 2.5, DEEP : 25mm

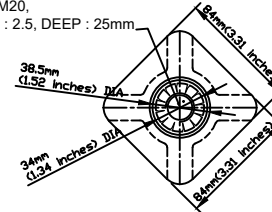

**NOTE:**

- TOP END FITTING IS MADE FROM ALUMINUM ALLOY & ANODIZED.
- BASE END FITTING IS MADE FROM STEEL FORGED & GALVANIZED.
- FIBERGLASS ROD IS MADE FROM EPOXY RESIN (ECR).
- CLAMP AND STUD BASE DIMENSIONS ARE IN ACCORDANCE WITH ANSI C29.18.
- THE DIA. OF FRP ROD IS 45mm(1.77 inches) SOLID.
- BASE AND INSULATOR ASSEMBLED WITH M20 BOLT AND WASHER.
- THE THICKNESS OF HOT DIP GALVANIZING SHALL BE MINIMUM 79 $\mu\text{m}$  ACCORDING TO ASTM A 153.
- THE TOLERANCE ON ALL DIMENSIONS SHALL BE AS FOLLOWS:  
 $\pm(0.04d+1.5)\text{mm}$  when  $d < 300\text{mm}$   
 $\pm(0.025d+6)\text{mm}$  when  $d > 300\text{mm}$  with a maximum of 50mm

**REVISIONS**

REV	LOCATION	NOTICE	DSN BY	APP BY	DATE
I/R		INITIAL RELEASE	J.H. PARK	C.H. PARK	06/17/2016
A		1. MOVED BOLT POSITION 2. CHANGED FIXED PIN SIZE (Ø5 to -) 3. ADDED MATERIAL DETAILS	B.J. KIM	D.H. YOO	07/25/2024

**DIMENSIONS**

LEAKAGE DISTANCE	2,330 mm
DRY ARCING DISTANCE	570 mm
SHEDS Q'TY	15 PCS

**MECHANICAL VALUES**

SPECIFIED CANTILEVER LOAD	12.5 kN
---------------------------	---------

**ELECTRICAL VALUES**

Low-Freq. WITHSTAND-WET	200 kV
IMPULSE WITHSTAND-POS	380 kV
IMPULSE WITHSTAND-NEG	470 kV

**PACKING INFORMATION**

NET WEIGHT EACH	9.05 kg
NO. IN STANDARD PACKAGE	1 PCS

**Material : Special Clamp**

1. Chemical Analysis (KS D 6008 : 2002) (Unit:wt%)

Element	Cu	Si	Mg	Zn	Fe	Mn
AC4CH	0.20 ↓	6.5~7.5	0.25~0.45	0.10 ↓	0.20 ↓	0.10 ↓
	0.05 ↓	0.20 ↓	0.05 ↓	0.05 ↓	0.05 ↓	Rest

2. Mechanical Properties (KS D 6008 : 2002)

AC4CH-T6	Tensile Strength (kgf/cm <sup>2</sup> )	Elongation (%)	Brinell Hardness [HB(10/500)]
	240 ↑	5 ↑	about 85

3. Heat Treatment (KS D 6008 : 2002)

AC4CH-T6	Method	Solution Treatment		Age Hardening Treatment	
		Temperature (°C)	Time (h)	Temperature (°C)	Time (h)
	Age Hardening treatment after Solution Treatment	about 535	about 8	about 155	about 6

**Material : Stud Base**

1. Chemical Analysis (KS D 3752 : 2019) (Unit:wt%)

Element	C	Si	Mn	P	S
S20C	0.18~0.23	0.15~0.35	0.30~0.60	0.030 ↓	0.035 ↓

2. Mechanical Properties (KS D 3752 : 2019)

S20C	Yield Point (kgf/cm <sup>2</sup> )	Tensile Strength (kgf/cm <sup>2</sup> )	Elongation (%)	Tightening (%)	Hardness (HB)
	25 ↑	41 ↑	26 ↑	-	116 ~ 174

3. Heat Treatment (KS D 3752 : 2019)

S20C	Method	Temperature (°C)
		Normalizing 870 ~ 920 (Air Cooling)

REPLACEABLE MATERIAL	NO	PART NAME	EA	MATERIAL	DWG NO	
<b>PART LISTS</b>						
ORIGINAL DWG	COMMON TOLERANCE	DATE	07/25/2024	<b>JTR</b>		
	DECIMAL ANGLE FRACTION	APP DIVISION	R&D Team			
	MATERIAL	CHK BY	KC.PARK APP BY			DH.YOO
	HEAT TREATMENT	DWG BY	BJ.KIM CHK BY			
		DSN BY	CHK BY	Polymer Line Post Insulator for Distribution (69kV HP Special Clamp)		
		DWG DIVISION	R&D Team			
RELEVANT DWG	APPLICABLE ITEM	CORROSION PROTECTION	SCALE	UNIT	WEIGHT	
PART NO			1:1	mm		
			SIZE	DWG NO		
			A3	LPSC-69SK-HP-M20		
			SHEET	1	OF 1	