

ALL DIMENSIONS IN MILLIMETRES - DO NOT SCALE - IF IN DOUBT PLEASE ASK

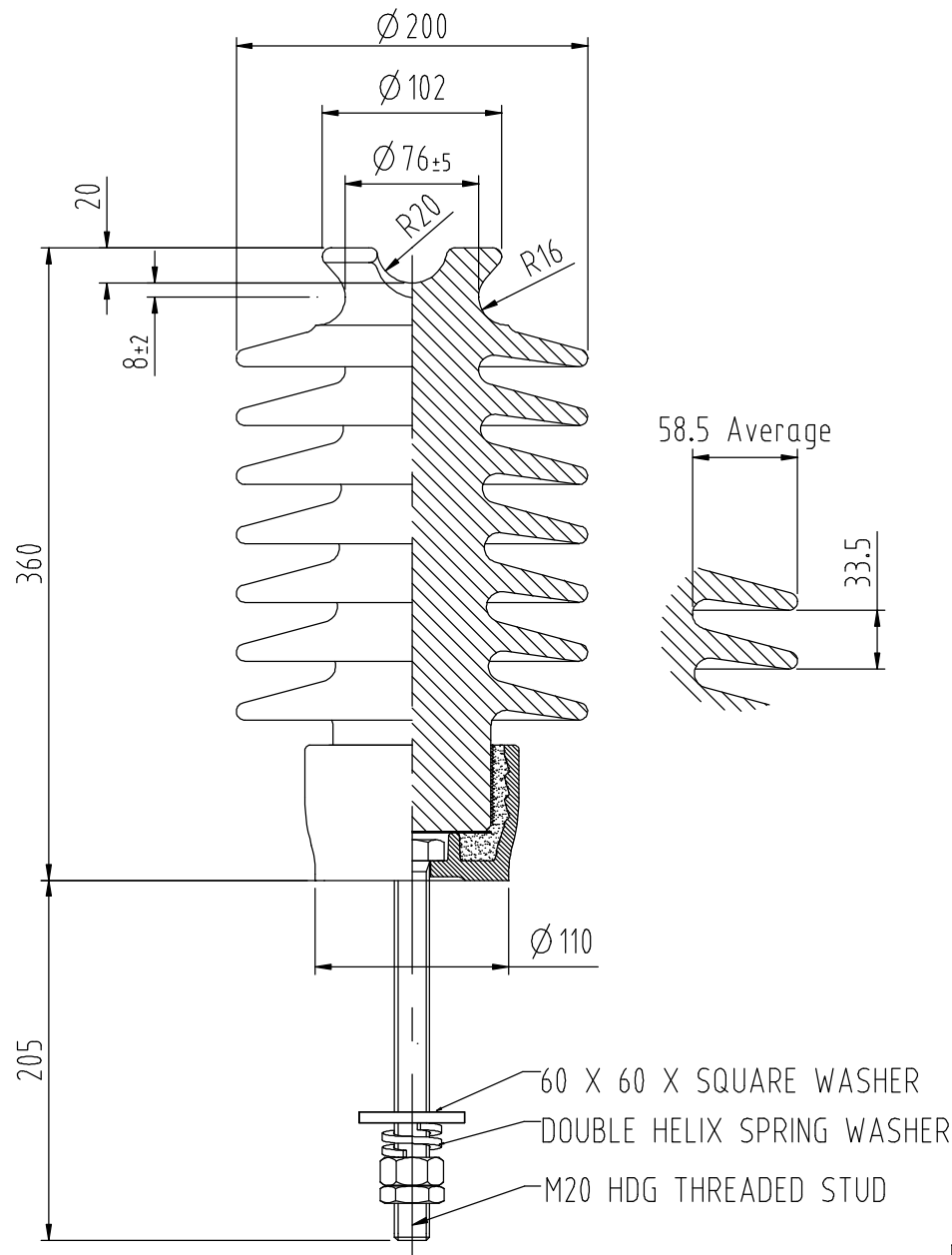

Technical Specification

	DESIGNED VALUES
<u>SYSTEM HIGHEST VOLTAGE</u>	36 kV
<u>WITHSTAND TEST VOLTAGES</u>	
a. Power frequency – wet (Vertical)	84 kV
b. Power frequency – wet (Horizontal)	99 kV
c. Power frequency – dry	112 kV
d. Lightning Impulse – dry (Calculated)	200 kV
<u>FLASHOVER TEST VOLTAGES</u>	
a. Power frequency – wet (Vertical)	89 kV
b. Power frequency – wet (Horizontal)	113 kV
c. Power frequency – dry	122 kV
<u>MINIMUM FAILING LOADS</u>	
a. Cantilever (Upright)	13.5 kN
<u>CREEPAGE DISTANCES</u>	
a. Total	915 mm
b. Protected	385 mm
c. Flashover	285 mm
Gross weight	12.5 kg
Pollution Performance N° (ESAA Publication D (b) 19-1975 ) =	

H	3484	11.1.13
G	3455	9.10.12
F	3426	16.5.12
E	3367	4.11.11
D	3341	19.8.11
C	3334	3.07.11
Issue Mod. No.	Date	

Drawn J.Bain  
Date 17.11.2010



NEW ZEALAND INSULATORS **nzi** TEMUKA

NEW ZEALAND INSULATORS LTD  
Tel: +64-3-687 8100  
Fax: +64-3-615 8125  
e-mail: sales@nzinsulators.co.nz

**36kV TIE TOP LINE POST**  
**Ø40 TOP GROOVE**

**D632-0571/H**