

ALL DIMENSIONS IN MILLIMETRES - DO NOT SCALE - IF IN DOUBT PLEASE ASK

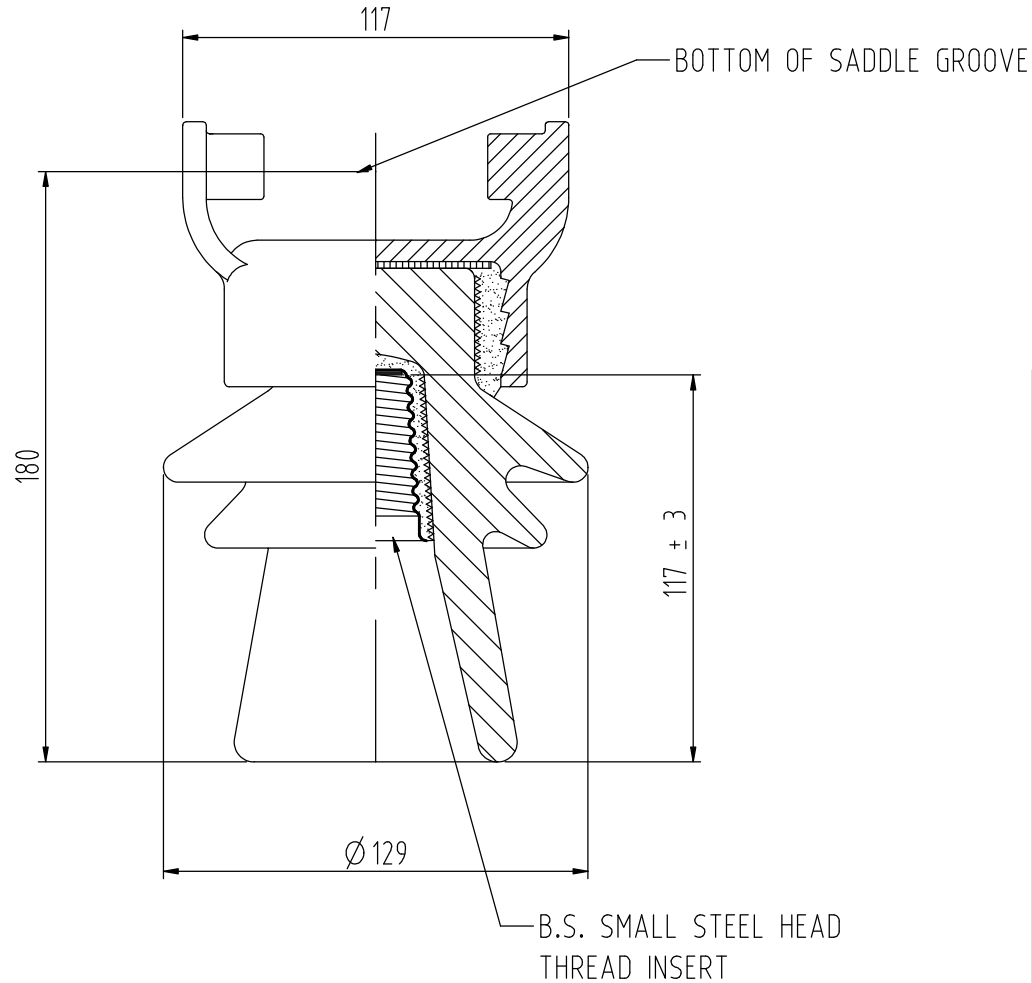

Technical Specification

ELECTRICAL CHARACTERISTICS

	DESIGNED VALUES
a. Nominal System Voltage	11 kV
b. Power Frequency withstand voltage – dry	50 kV
c. Power Frequency withstand voltage – wet	30 kV
d. Power Frequency flashover voltage – dry	70 kV
e. Power Frequency flashover voltage – wet	45 kV
f. Power Frequency withstand puncture voltage	>125 kV
g. Lightning Impulse withstand voltage – dry	95 kV
h. Lightning Impulse flashover voltage – dry	120 kV

MECHANICAL CHARACTERISTICS

q. Minimum failing load – Cantilever (Dependant on pin)	7–11 kN
---	---------

PHYSICAL CHARACTERISTICS

a. Nominal minimum creepage distance	250 mm
b. Nominal protected creepage distance	125 mm
c. Nominal flashover distance	150 mm
d. Nominal net weight	4.7 kg

Issue	Mod. No.	Date
D	3466	5.12.12
C	2880	3.3.01
B	CAD	

Drawn J. Bain
Date 15.12.1994

FIRST ANGLE PROJECTION

NEW ZEALAND INSULATORS



TEMUKA

NEW ZEALAND INSULATORS LTD
Tel: +64-3-615 0085
Fax: +64-3-615 8125
e-mail: sales@nzinsulators.co.nz

Cat. N°. 1132T
11kV CLAMP TOP C/W SSH THREAD INSERT

D351-0502/D