

The page features several thin, curved lines in a light brown color that sweep across the top and left sides, creating a sense of movement and design.

NEW ZEALAND INSULATORS



TEMUKA

> 2014 LV POCKET BOOK



December 2013

NZI re-entered the LV market in October 2012 and we have expanded the range since then. We can now provide you with this 2014 LV Pocket Book, which is representative of the Low Voltage product range we are offering to New Zealand Wholesalers.

Our range covers all the usual things – NZI lamp holders, connectors, DMC standoffs, busbar supports, reels, fuse holders and fuse carriers, safety bases – all available direct from NZI – and all made by us in Temuka.

Experienced industry players know that NZI products last and last.

Of particular importance to us are the NZI branded products, which are the products we make in Temuka, South Canterbury. We all know about imported products which have flooded this market, but with your support we can retain manufacturing in New Zealand, and keep New Zealanders employed. So why not support the NZI brand and the quality products we stand for.

We also offer Wholesalers an extensive range of genuine Cooper Bussmann (from Bussmann by EATON) fuses, fuse holders and switch disconnects. As well as, Fulton Industries earthing products and Avon products all ex stock.

The NZI warehouses in Temuka (South Canterbury) and Kumeu (West Auckland) supply the range of LV products for dispatch on an overnight basis, providing your order is in by 3pm. The minimum value of LV orders to qualify for freight-free NZ-wide is \$300 + GST (see Freight Rate Card on www.nzinsulators.co.nz).

Please deal directly through our Temuka Customer Services on 03-6878100, fax 03-6158125 or email sales@nzinsulators.co.nz

We appreciate you supporting a New Zealand business standing for quality products.

Chris van der Werff

General Manager

New Zealand Insulators Limited

Mobile 027 7066 205

Email chris@nzinsulators.co.nz

Why pay a small premium for NZI Temuka-made product?

1. **Our product lasts** – please assess the cost across our product's entire lifetime.
2. **Trusted porcelain** – NZI's Kakahu blend, from our own mine in South Canterbury, proven & trusted.
3. **Durability** – our porcelain is lighter, stronger and can take the knocks.
4. **Tested** – our products are tested at 7 stages throughout manufacture, we weed out every reject.
5. **QA System** – we manufacture to an ISO9001 certified quality system.
6. **Use it or lose it** – future proof your choices, and retain our local manufacturing capability.
7. **Safe haven** – imports are cheap today, but things tend to go in cycles.
8. **Compliance** – NZI complies with our local standards, as well as environmental, safety, employment & intellectual property regulations.
9. **Actually made here** – because many of your clients will prefer, and attach value to, NZ-made products.
10. **Specify NZ made product** – keep the resources, the infrastructure, the skills, the pride, the money, the people and the precious employment right here. Handing these things offshore to someone else is madness (opinion).

FREE NZI DISPLAY BOX

No charge, just add some to your order:



NZI Wholesaler Display Box

Part Number 804479

20/pack

Complimentary

CONTENTS

NZI BRAND made in Temuka

NZI Connectors	2
NZI Lampholders	3
NZI Reel Bundles	4
NZI Reels & Spike	5
NZI Mini Wedge Fuseholder	5
NZI DMC Standoffs	6
NZI Busbar Supports	7
NZI MCB Safety Bases	8
NZI Fuseholders	10, 12
NZI J-Type Fuse Carriers	26-27

COOPER BUSSMANN made in India/UK

Red Spot & Camaster Fuseholders	9, 11, 12
Bussmann Industrial Fuses	13-15
Bussmann Motor Circuit Fuses	16
Bussmann House Service Fuses	17
Bussmann DIN Fuse Disconnects	19
Bussmann DIN Fuses	23-25
Bussmann Cylindrical Fuses	26
Bussmann High Speed T-Type Fuses	27-28
Bussmann J-Type Fuses	29-30
Bussmann Bottle Fuses	31
Bussmann 12kV Fuse Selection	32
NZ Insulators Fusible Solutions	33
HRC Fuselinks Compatibility Chart	34

EFEN made in Germany

Efen DIN Fuse Disconnects	18
---------------------------	----

AVON INDUSTRIES made in Whangarei

Avon Shackle Straps & U Shackles	4
Avon HDG & Stainless Earth Rods	20

FULTON INDUSTRIES made in Gosford

Fulton Copper-Clad Earth Rods	21
Fulton Clamps & Connectors	22





1004



3004 Side View



2005CFH



1005 & 2005



3005



2004

1/2/3 WAY PORCELAIN CONNECTORS (AS/NZS 60998)

Part Number	Description	Brand	Origin	Voltage	Rating	Fixing Hole	Glaze	Weight	Box Qty	Unit	Trade NZ\$
15A Connectors											
184012	NZI 1004 1-Way Connector	NZI	NZ	500V	15A	None	Unglazed	9g	28	Each	9.30
184047	NZI 2004 2-Way Connector	NZI	NZ	500V	15A	None	Clear	16g	18	Each	11.70
184063	NZI 2004CFH 2-Way Connector	NZI	NZ	500V	15A	Centre	Clear	21g	12	Each	11.80
184098	NZI 3004 3-Way Connector	NZI	NZ	500V	15A	None	Clear	23g	12	Each	12.20
184128	NZI 3004CFH 3-Way Connector	NZI	NZ	500V	15A	Centre	Clear	30g	9	Each	13.00
30A Connectors											
184144	NZI 1005 1-Way Connector	NZI	NZ	500V	30A	None	Clear	32g	14	Each	10.10
184179	NZI 2005 2-Way Connector	NZI	NZ	500V	30A	None	Clear	33g	8	Each	16.90
184195	NZI 2005CFH 2-Way Connector	NZI	NZ	500V	30A	Centre	Clear	52g	6	Each	17.10
184217	NZI 3005 3-Way Connector	NZI	NZ	500V	30A	None	Clear	57g	6	Each	27.90
184233	NZI 3005CFH 3-Way Connector	NZI	NZ	500V	30A	Centre	Clear	77g	4	Each	28.50
60A Connectors											
184276	NZI 2006CFH 2-Way Connector	NZI	NZ	500V	60A	Centre	Clear	105g	1	Each	33.10
184284	NZI 3006CFH 3-Way Connector	NZI	NZ	500V	60A	Centre	Clear	150g	1	Each	42.10



'R' RESTRICTED-MOUNTING LAMP HOLDERS (ES/GES to AS/NZS 60998, BC to AS 3117)

Part Number	Description	Brand	Origin	Voltage	Rating	Mounting	Shrouding	Glaze	Weight	Box Qty	Unit	Trade NZ\$
Bayonet Cap Lampholders												
164046	NZI BC 960 Lampholder	NZI	NZ	240V	5A	External Side	Unshrouded	Clear	70g	8	Each	30.00
164054	NZI BC 961 Lampholder	NZI	NZ	240V	5A	External Back (2-Pin Batten)	Unshrouded	Clear	60g	8	Each	28.00
Edison Screw Lampholders												
164194	NZI ES 971 Lampholder	NZI	NZ	240V	5A	External Back	Unshrouded	Clear	85g	8	Each	24.50
164216	NZI ES 975 Lampholder	NZI	NZ	240V	5A	Internal Back	Unshrouded	Clear	70g	8	Each	26.80
166316	NZI ES 970 Lampholder	NZI	NZ	240V	5A	External Side	Unshrouded	Clear	105g	8	Each	27.50
164275	NZI ES T10 Lampholder	NZI	NZ	240V	5A	Ext. Back (HD)	Unshrouded	Clear	75g	8	Each	26.80
Giant Edison Screw Lampholders												
164011	NZI GES 926 Lampholder	NZI	NZ	650V	15A	Internal Back	Shrouded	White	260g	6	Each	32.20
164038	NZI GES 926-1 Lampholder	NZI	NZ	650V	15A	Internal Back	Unshrouded	White	245g	6	Each	32.20
164380	NZI GES 926-3 Lampholder	NZI	NZ	650V	15A	Internal Back	Unshrouded	White	225g	6	Each	30.80

AVON SHACKLES & NZI Reel BUNDLES



SHACKLE STRAPS & U SHACKLES

Part Number	Description	Brand	Origin	Length	Width	Thick	Holes	HDG	Weight	Box Qty	Unit	Trade NZ\$
Shackle Straps												
537004	Avon AA20001 Shackle Strap 7"	Avon	NZ	180mm	32mm	3mm	14mm	To AS/NZS 4680:2006	140g	100	Each	2.70
537012	Avon AA20009 Shackle Strap #11	Avon	NZ	170mm	30mm	2mm	14mm	To AS/NZS 4680:2006	85g	200	Each	2.40
537020	Avon AA20011 Shackle Strap #8 Offset	Avon	NZ	180mm	32mm	3mm	18mm	To AS/NZS 4680:2006	130g	100	Each	7.50
U Shackles												
537039	Avon AA23001 210 U Shackle Small	Avon	NZ	85mm	32mm	3mm	14mm	To AS/NZS 4680:2006	160g	100	Each	4.70
537047	Avon AA23002 205 U Shackle Large	Avon	NZ	105mm	32mm	3mm	14mm	To AS/NZS 4680:2006	210g	50	Each	8.00
537063	Avon AA23003 320 U Shackle Extra Large	Avon	NZ	132mm	40mm	5mm	14mm	To AS/NZS 4680:2006	500g	30	Each	14.10

PREASSEMBLED REEL BUNDLES

Part Number	Description	Origin	Assembled	Weight	Box Qty	Unit	Trade NZ\$
Reel & Shackle Strap Bundles							
102148	NZI 210 Reel + Avon 7" Shackle Strap + 2 x M12 110 Bolt	NZ	Preassembled	750g	20	Bundle	16.20
102180	NZI 205 Reel + Avon 7" Shackle Strap + 2 x M12 110 Bolt	NZ	Preassembled	1.1kg	10	Bundle	22.90
Reel & U-Shackle Bundles							
102121	NZI 210 Reel + Avon Small U Shackle + M12 110 Bolt	NZ	Preassembled	550g	20	Bundle	13.00
102156	NZI 205 Reel + Avon E/Large U Shackle + M12 110 Bolt	NZ	Preassembled	1.2kg	10	Bundle	26.60





PORCELAIN LV REELS, SPIKE & FENCE STRAIN

Part Number	Description	Brand	Origin	Rating	Groove	Load	Detail	Glaze	Weight	Box Qty	Unit	Trade NZ\$
Reels/Bobbins												
109029	NZI 120 Reel	NZI	NZ	650V	13mm	4.5kN	14mm Diameter	Clear	130g	30	Each	2.00
109207	NZI 210 Reel	NZI	NZ	650V	10mm	6kN	17.5mm Diameter	Grey	220g	80	Each	3.70
109061	NZI 220 Reel	NZI	NZ	650V	19mm	5.5kN	17mm Diameter	Grey	295g	80	Each	3.70
109088	NZI 224 Trurip Reel	NZI	NZ	650V	25.5mm	13.5kN	17.5mm Diameter	Grey	385g	34	Each	6.30
109010	NZI 205 Reel	NZI	NZ	3.3kV	18mm	10kN	17.5mm Diameter	Grey	540g	42	Each	7.20
Spike												
100501	NZI 103 Spike	NZI	NZ		16mm Hole	4kN	Coach Screw	Grey	325g	50	Each	14.60
Fence Strain												
108014	NZI 107 Fence Strain	NZI	NZ	4kV			57mm Height	Clear	135g	140	Each	8.00
Mini Wedge Fuseholder (AS/NZS 3947)												
468789	NZI Mini Wedge Carrier/Base Complete	NZI	NZ	200A	Offset Tag Fuses		Porcelain & ETPNFM	Grey	3.0kg	5	Each	186.80

NZI DMC STANDOFFS



M8 DMC Standoffs



M10 DMC Standoffs

DMC STANDOFFS WITH STEEL INSERTS

Part Number	Description	Brand	Origin	Rating	Inserts	Height	Colour	Construction	Weight	Box Qty	Unit	Trade NZ\$
M8 DMC Standoffs (IEC 60660)												
515191	NZI 6/35/M8 DMC Standoff	NZI	NZ	1.5kV	M8	35mm	Grey	DMC & Zinc-Plated Steel	95g	12	Each	16.00
515221	NZI 6/38/M8 DMC Standoff	NZI	NZ	1.5kV	M8	38mm	Grey	DMC & Zinc-Plated Steel	110g	12	Each	19.30
515264	NZI 6/45/M8 DMC Standoff	NZI	NZ	1.5kV	M8	45mm	Grey	DMC & Zinc-Plated Steel	135g	12	Each	21.90
514705	NZI 6/50/M8 DMC Standoff	NZI	NZ	1.5kV	M8	50mm	Grey	DMC & Zinc-Plated Steel	155g	12	Each	24.00
M10 DMC Standoffs (IEC 60660)												
515299	NZI 6/35/M10 DMC Standoff	NZI	NZ	1.5kV	M10	35mm	Grey	DMC & Zinc-Plated Steel	90g	12	Each	16.00
515329	NZI 6/38/M10 DMC Standoff	NZI	NZ	1.5kV	M10	38mm	Grey	DMC & Zinc-Plated Steel	105g	12	Each	19.30
515353	NZI 6/45/M10 DMC Standoff	NZI	NZ	1.5kV	M10	45mm	Grey	DMC & Zinc-Plated Steel	130g	12	Each	21.90
514772	NZI 6/50/M10 DMC Standoff	NZI	NZ	1.5kV	M10	50mm	Grey	DMC & Zinc-Plated Steel	150g	12	Each	24.00



M6 Busbar Support



M8 Busbar Support



M10 Busbar Support



M12 Busbar Support

PORCELAIN BUSBAR SUPPORTS – COMPLETE WITH BOLT (IEC 60273)

Part Number	Description	Brand	Origin	Rating	Bolt	Material	Glaze	Weight	Box Qty	Unit	Trade NZ\$
3kV Busbar Supports											
186104	NZI M6 Busbar Support	NZI	NZ	3kV	M6 (1/4")	Porcelain & Z/plated Steel	White	171g	6	Each	15.10
185043	NZI M8 Busbar Support	NZI	NZ	3kV	M8 (5/16")	Porcelain & Z/plated Steel	White	185g	6	Each	17.70
186112	NZI M10 Busbar Support	NZI	NZ	3kV	M10 (3/8")	Porcelain & Z/plated Steel	White	215g	6	Each	21.40
186120	NZI M12 Busbar Support	NZI	NZ	3kV	M12 (1/2")	Porcelain & Z/plated Steel	White	330g	6	Each	28.00



New Charcoal NZI Flame-Retardant MCB Safety Bases



Polyester Butylene Terephthalate



Made in New Zealand

UNIVERSAL MCB SAFETY BASES (AS/NZS 3121)

Part Number	Description	Brand	Origin	Voltage	Rating	Material	Colour	Weight	Box Qty	Unit	Trade NZ\$
Back Entry Safety Base											
631779*	NZI Back Entry Plastic Safety Base	NZI	NZ	240V	6-40A	Glass-Reinforced Polyester Resin	Charcoal	26g	36	Each	2.80
End Entry Safety Base											
631809*	NZI End Entry Plastic Safety Base	NZI	NZ	240V	6-40A	Glass-Reinforced Polyester Resin	Charcoal	24g	36	Each	3.00

* Limited stock available.



32A Safeloc & Safeclip FUSEHOLDERS



Economy G06



Safeclip SC32H



Safeloc 32NNSF



Safeloc 32NNSBS

32A FUSEHOLDERS FOR STAGGERED TAG FUSELINKS

Part Number	Description	Brand	Origin	Rating	Voltage	Configuration	Colour	Weight	Box Qty	Unit	Trade NZ\$
Economy G06 Fuseholders (AS/NZS 60269)											
540161	32A G06 EE/EE Fuseholder	Unbranded	China	32A	550V	End Entry End Entry	Black	85g	5	Each	13.20
540757	32A G06 BE/BE Fuseholder	Unbranded	China	32A	550V	Back Entry Back Entry	Black	85g	5	Each	13.20
Safeloc NSD Fuseholders (IEC 60269)											
545007	Bussmann 32NNSF Front Wired	Bussmann	India	32A	415V	Front Wired Front Wired	Black	85g	10	Each	15.10
545015	Bussmann 32NNSR Back Wired	Bussmann	India	32A	415V	Back Wired Back Wired	Black	85g	10	Each	15.10
540803	Bussmann 32NNSBS Back Stud	Bussmann	India	32A	415V	Back Stud Back Stud	Black	115g	10	Each	20.70
545023	Bussmann 32NNSFBS Front Wired Back Stud	Bussmann	India	32A	415V	Front Wired Back Stud	Black	100g	10	Each	31.20
Safeclip NSD Fuseholder (IEC 60629)											
545031	Bussmann GE SC32H Front Wired	Bussmann	UK	32A		Front Wired Front Wired	Black	95g	10	Each	18.80

NZI 63A K07 FUSEHOLDERS



BS/BE

EB/EE



NZI 63A K07 Fuseholders, made in Temuka



Side View



BE/BE

63A HG PHENOLIC FUSEHOLDERS FOR OFFSET TAG FUSELINKS

Part Number	Description	Brand	Origin	Amps	Rating	Configuration	Colour	Weight	Box Qty	Unit	Trade NZ\$
63A K07 Fuseholders (AS/NZS 60269)											
676004	NZI K07 63A EE/EE	NZI	NZ	63A	500V	End Entry End Entry	Black	260g	6	Each	39.80
676012	NZI K07 63A BE/BE	NZI	NZ	63A	500V	Back Entry Back Entry	Black	270g	6	Each	41.90
676020	NZI K07 63A BE/EE	NZI	NZ	63A	500V	Back Entry End Entry	Black	265g	6	Each	44.40
678023	NZI K07 63A BS/BE	NZI	NZ	63A	500V	Back Stud Back Entry	Black	320g	6	Each	48.50
678031	NZI K07 63A BS/EE	NZI	NZ	63A	500V	Back Stud End Entry	Black	320g	6	Each	48.50
678058	NZI K07 63A BB/EE	NZI	NZ	63A	500V	Back Busbar End Entry	Black	290g	6	Each	47.40
678066	NZI K07 63A EB/EE	NZI	NZ	63A	500V	End Busbar End Entry	Black	280g	6	Each	47.40
678074	NZI K07 63A EB/BE	NZI	NZ	63A	500V	End Busbar Back Entry	Black	280g	6	Each	47.40
678007	NZI K07 63A BS/BS	NZI	NZ	63A	500V	Two Back Studs	Black	380g	6	Each	56.10





Red Spot Fuseholders now through NZI



Camaster CM63F



Red Spot RS63H

63A FUSEHOLDERS FOR OFFSET TAG FUSELINKS

Part Number	Description	Brand	Origin	Rating	Voltage	Configuration	Colour	Weight	Box Qty	Unit	Trade NZ\$
Red Spot 63A Fuseholders (IEC 60269)											
692824	Red Spot RS63H Front Wired	Bussmann	UK	63A	690V	Front Wired Front Wired	Black	310g	10	Each	49.80
692832	Red Spot RS63P Back Stud	Bussmann	UK	63A	690V	Back Stud Back Stud	Black	450g	10	Each	64.20
692840	Red Spot RS63PH Front Wired BS	Bussmann	UK	63A	690V	Front Wired Back Stud	Black	380g	10	Each	64.20
692859	Red Spot RS63HWH Front Wired White	Bussmann	UK	63A	690V	Front Wired Front Wired	White	310g	10	Each	45.60
692867	Red Spot RS63PWH Back Stud White	Bussmann	UK	63A	690V	Back Stud Back Stud	White	450g	10	Each	67.80
Camaster 63A Cam Action Fuseholders (IEC 60269)											
692034	Camaster CM63F Front Wired	Bussmann	India	63A	690V	Front Wired Front Wired	Black	200g	5	Each	52.00
692816	Camaster CM63FW Front Wired White	Bussmann	India	63A	690V	Front Wired Front Wired	White	200g	5	Each	52.00
692123	63/100BS Back Stud for Camaster 63A/100A	Bussmann	India	63/100A	690V	Back Stud Accessory	Black	60g	5	Each	30.50

VARIOUS 100+A FUSEHOLDERS



100+A FUSEHOLDERS FOR OFFSET & CENTRAL TAG FUSELINKS

Part Number	Description	Brand	Origin	Rating	Voltage	Configuration	Colour	Weight	Box Qty	Unit	Trade NZ\$
NZI 100A L14 Fuseholder (BS88 Part2 1975)											
678678	NZI L14 100A EE/EE Fuseholder	NZI	NZ	100A	500V	End Entry End Entry	Black	870g	5	Each	144.90
Red Spot 100/200/400A Fuseholders (IEC 60269)											
692905	Red Spot RS100H Front Wired 100A	Bussmann	UK	100A	690V	Front Wired Front Wired	Black	850g	5	Each	110.60
692875	Bussmann Red Spot RS100BW Back Wired 100A	Bussmann	UK	100A	690V	Back Wired Back Wired	Black	795g	5	Each	157.10
692913	Red Spot RS100P Back Stud 100A	Bussmann	UK	100A	690V	Back Stud Back Stud	Black		5	Each	163.90
692921	Red Spot RS100PH Front Wired BS 100A	Bussmann	UK	100A	690V	Front Wired Back Stud	Black	915g	5	Each	166.20
692948	Red Spot RS200H Front Wired 200A	Bussmann	UK	200A	690V	Front Wired Front Wired	Black	2.1kg	1	Each	408.50
692956	Red Spot RS400H Front Wired 400A	Bussmann	UK	400A	690V	Front Wired Front Wired	Black		1	Each	1,695.80
Camaster 100A Cam Action Fuseholder (IEC 60269)											
692042	Camaster CM100F Front Wired	Bussmann	India	100A	690V	Front Wired Front Wired	Black		5	Each	124.20
692123	63/100BS Back Stud for Camaster 63A/100A	Bussmann	India	63/100A	690V	Back Stud Accessory	Black	60g	5	Each	30.50



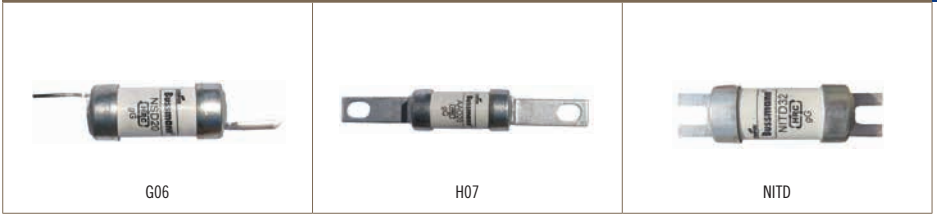

G06, H07 & NITD FUSELINKS (CLASS gG)

Part Number	Description	Brand	Origin	Amps	Volts	Break	Tags	Box Qty	Unit	Trade NZ\$
G06 Staggered HRC Fuselinks										
644609	2G06 (NSD2)	Bussmann	India	2A	550V	80kA	Staggered	20	Each	2.70
644617	4G06 (NSD4)	Bussmann	India	4A	550V	80kA	Staggered	20	Each	2.70
644625	6G06 (NSD6)	Bussmann	India	6A	550V	80kA	Staggered	20	Each	2.70
644633	10G06 (NSD10)	Bussmann	India	10A	550V	80kA	Staggered	20	Each	2.70
644641	16G06 (NSD16)	Bussmann	India	16A	550V	80kA	Staggered	20	Each	3.30
644668	20G06 (NSD20)	Bussmann	India	20A	550V	80kA	Staggered	20	Each	3.30
646881	25G06 (NSD25)	Bussmann	India	25A	550V	80kA	Staggered	20	Each	3.50
646903	32G06 (NSD32)	Bussmann	India	32A	550V	80kA	Staggered	20	Each	3.50
H07 Offset HRC Fuselinks										
645303	2H07 (AA02)	Bussmann	India	2A	550V	80kA	Offset Bolted	20	Each	3.80
645311	4H07 (AA04)	Bussmann	India	4A	550V	80kA	Offset Bolted	20	Each	3.80
645338	6H07 (AA06)	Bussmann	India	6A	550V	80kA	Offset Bolted	20	Each	3.80
645346	10H07 (AA010)	Bussmann	India	10A	550V	80kA	Offset Bolted	20	Each	3.80
645354	16H07 (AA016)	Bussmann	India	16A	550V	80kA	Offset Bolted	20	Each	5.10
645362	20H07 (AA020)	Bussmann	India	20A	550V	80kA	Offset Bolted	20	Each	5.10
645370	25H07 (AA025)	Bussmann	India	25A	550V	80kA	Offset Bolted	20	Each	5.40
645389	32H07 (AA032)	Bussmann	India	32A	550V	80kA	Offset Bolted	20	Each	5.40
NITD Offset HRC Fuselinks										
641332	NITD2	Bussmann	India	2A	550V	80kA	Offset Slotted	20	Each	2.70
641340	NITD4	Bussmann	India	4A	550V	80kA	Offset Slotted	20	Each	2.70
641359	NITD6	Bussmann	India	6A	550V	80kA	Offset Slotted	20	Each	2.70
641367	NITD10	Bussmann	India	10A	550V	80kA	Offset Slotted	20	Each	2.70
641375	NITD16	Bussmann	India	16A	550V	80kA	Offset Slotted	20	Each	3.30
641383	NITD20	Bussmann	India	20A	550V	80kA	Offset Slotted	20	Each	3.30
641391	NITD25	Bussmann	India	25A	550V	80kA	Offset Slotted	20	Each	3.50
641405	NITD32	Bussmann	India	32A	550V	80kA	Offset Slotted	20	Each	3.50

COOPER BUSSMANN HRC BS88 FUSELINKS



K07



L14



M14



L09

K07, L14, M14 & L09 FUSELINKS (CLASS gG)

Part Number	Description	Brand	Origin	Amps	Volts	Break	Tags	Unit	Box Qty	Unit	Trade NZ\$
K07 Offset HRC Fuselinks											
645664	40K07 (BA040)	Bussmann	India	40A	550V	80kA	Offset	Each	20	Each	6.80
645680	50K07 (BA050)	Bussmann	India	50A	550V	80kA	Offset	Each	20	Each	6.80
645702	63K07 (BA063)	Bussmann	India	63A	550V	80kA	Offset	Each	20	Each	6.80
692336	80K07R (OSD80)	Bussmann	India	80A	550V	80kA	Offset	Each	20	Each	9.90
692344	100K07R (OSD100)	Bussmann	India	100A	550V	80kA	Offset	Each	20	Each	9.90
L09 Offset HRC Fuselinks											
646458	80L09 (CD80)	Bussmann	India	80A	550V	80kA	Offset	Each	10	Each	16.50
646466	100L09 (CD100)	Bussmann	India	100A	550V	80kA	Offset	Each	10	Each	16.50
L14 Offset HRC Fuselinks											
646512	32L14 (CE032)	Bussmann	India	32A	550V	80kA	Offset	Each	10	Each	13.90
646520	40L14 (CE040)	Bussmann	India	40A	550V	80kA	Offset	Each	10	Each	13.90
646539	50L14 (CE050)	Bussmann	India	50A	550V	80kA	Offset	Each	10	Each	13.90
646547	63L14 (CE063)	Bussmann	India	63A	550V	80kA	Offset	Each	10	Each	13.90
646555	80L14 (CE080)	Bussmann	India	80A	550V	80kA	Offset	Each	10	Each	13.90
646563	100L14 (CE0100)	Bussmann	India	100A	550V	80kA	Offset	Each	10	Each	13.90
M14 Offset HRC Fuselinks											
646636	125M14 (DE0125)	Bussmann	India	125A	415V	80kA	Offset	Each	5	Each	19.70
646652	160M14 (DE0160)	Bussmann	India	160A	415V	80kA	Offset	Each	5	Each	19.70
646660	200M14 (DE0200)	Bussmann	India	200A	415V	80kA	Offset	Each	5	Each	19.70



M09, N09, P09, N11, P11 & R11 FUSELINKS (CLASS gG)

Part Number	Description	Brand	Origin	Amps	Volts	Break	Tags	Box Qty	Unit	Trade NZ\$
M09 Central HRC Fuselinks										
646571	125M09 (DD125)	Bussmann	India	125A	415V	80kA	Central	5	Each	27.30
646601	160M09 (DD160)	Bussmann	India	160A	415V	80kA	Central	5	Each	28.70
646628	200M09 (DD200)	Bussmann	India	200A	415V	80kA	Central	5	Each	29.00
N09 Central HRC Fuselinks										
646709	250N09 (ED250)	Bussmann	India	250A	415V	80kA	Central	1	Each	44.40
646717	315N09 (ED315)	Bussmann	India	315A	415V	80kA	Central	1	Each	44.40
P09 Central HRC Fuselinks										
646679	355P09 (ED355)	Bussmann	India	355A	415V	80kA	Central	1	Each	45.30
646687	400P09 (ED400)	Bussmann	India	400A	415V	80kA	Central	1	Each	45.30
N11 Central HRC Fuselinks										
646768	250N11 (EFS250)	Bussmann	India	250A	415V	80kA	Central	1	Each	34.00
646776	315N11 (EFS315)	Bussmann	India	315A	415V	80kA	4-Hole Central	1	Each	58.60
P11 Central HRC Fuselinks										
647942	355P11 (EF355)	Bussmann	India	355A	415V	80kA	4-Hole Central	1	Each	58.60
646644	400P11 (EF400)	Bussmann	India	400A	415V	80kA	4-Hole Central	1	Each	59.20
R11 Central HRC Fuselinks										
646946	450R11 (FF450)	Bussmann	India	450A	550V	80kA	4-Hole Central	1	Each	158.10
646954	500R11 (FF500)	Bussmann	India	500A	550V	80kA	4-Hole Central	1	Each	161.20
646962	560R11 (FF560)	Bussmann	India	560A	550V	80kA	4-Hole Central	1	Each	164.20
646970	630R11 (FF630)	Bussmann	India	630A	550V	80kA	4-Hole Central	1	Each	170.30

COOPER BUSSMANN HRC BS88 FUSELINKS



G06 Motor Circuit



H07 Motor Circuit



K07 Motor Circuit



P11 Motor Circuit

MOTOR CIRCUIT FUSELINKS (CLASS gG)

Part Number	Description	Brand	Origin	Amps	Volts	Break	Tags	Box Qty	Unit	Trade NZ\$
G06 HRC Motor Circuit Fuses										
649201	20M25 G06 MC (NSD20M25)	Bussmann	India	20M25	415V	80kA	Staggered	20	Each	5.60
649228	20M32 G06 MC (NSD20M32)	Bussmann	India	20M32	415V	80kA	Staggered	20	Each	5.60
649236	32M40 G06 MC (NSD32M40)	Bussmann	India	32M40	415V	80kA	Staggered	20	Each	7.00
H07 HRC Motor Circuit Fuses										
649368	32M40 H07 MC (AA032M40)	Bussmann	India	32M40	550V	80kA	Offset	20	Each	7.40
649384	32M50 H07 MC (AA032M50)	Bussmann	India	32M50	550V	80kA	Offset	20	Each	7.40
649392	32M63 H07 MC (AA032M63)	Bussmann	India	32M63	550V	80kA	Offset	20	Each	7.40
K07 HRC Motor Circuit Fuses										
649457	63M80 K07 MC (BA063M80)	Bussmann	India	63M80	550V	80kA	Offset	20	Each	8.90
649465	63M100 K07 MC (BA063M100)	Bussmann	India	63M100	550V	80kA	Offset	20	Each	8.90
Other HRC Motor Circuit Fuses										
649651	100M125 L09 MC (CD100M125)	Bussmann	India	100M125	415V	80kA	Central	10	Each	57.80
649597	100M125 L14 MC (CEO100M125)	Bussmann	India	100M125	415V	80kA	Offset	10	Each	41.80
649678	100M160 L09 MC (CD100M160)	Bussmann	India	100M160	415V	80kA	Central	10	Each	57.80
649619	100M160 L14 MC (CEO100M160)	Bussmann	India	100M160	415V	80kA	Offset	10	Each	41.80
649627	100M200 L14 MC (CEO100M200)	Bussmann	India	100M200	415V	80kA	Offset	10	Each	41.80
649694	200M250 M09 MC (DD200M250)	Bussmann	India	200M250	415V	80kA	Central	5	Each	60.10
649643	200M250 M14 MC (DE0200M250)	Bussmann	India	200M250	415V	80kA	Offset	5	Each	43.30
649724	315M400 N09 MC (ED315M400)	Bussmann	India	315M400	550V	80kA	Central	1	Each	81.50
646695	400M500 P09 MC (ED400M500)	Bussmann	India	400M500	415V	80kA	Central	1	Each	205.10
647950	400M500 P11 MC (EF400M500)	Bussmann	India	400M500	550V	80kA	Central	1	Each	327.20



60KR85

KR85 HOUSE SERVICE FUSELINKS (CLASS gG)

Part Number	Description	Brand	Origin	Amps	Volts	Break	Configuration	Standard	Box Qty	Unit	Trade NZ\$
KR85 HRC House Service Fuses											
647802	5A (5KR85)	Bussmann	India	5A	415V	33kA	22x57mm Ferrule	BS1361	20	Each	4.10
647810	10A (10KR85)	Bussmann	India	10A	415V	33kA	22x57mm Ferrule	BS1361	20	Each	4.10
647829	15A (15KR85)	Bussmann	India	15A	415V	33kA	22x57mm Ferrule	BS1361	20	Each	4.10
647837	20A (20KR85)	Bussmann	India	20A	415V	33kA	22x57mm Ferrule	BS1361	20	Each	4.10
647853	30A (30KR85)	Bussmann	India	30A	415V	33kA	22x57mm Ferrule	BS1361	20	Each	4.10
647861	40A (40KR85)	Bussmann	India	40A	415V	33kA	22x57mm Ferrule	BS1361	20	Each	4.10
647888	45A (45KR85)	Bussmann	India	45A	415V	33kA	22x57mm Ferrule	BS1361	20	Each	4.10
647896	50A (50KR85)	Bussmann	India	50A	415V	33kA	22x57mm Ferrule	BS1361	20	Each	4.10
647918	60A (60KR85)	Bussmann	India	60A	415V	33kA	22x57mm Ferrule	BS1361	20	Each	4.10
647926	80A (80KR85)	Bussmann	India	80A	415V	33kA	22x57mm Ferrule	BS1361	20	Each	4.80
647934	100A (100KR85)	Bussmann	India	100A	415V	33kA	22x57mm Ferrule	BS1361	20	Each	5.50

EFEN DIN SWITCHES



NH00 Base



NH1 Base



NH2 Base



NH1 3P3P



NH2 1PSP

EFEN DIN FUSE DISCONNECTS

Part Number	Description	Brand	Origin	Efen Code	Amps	Poles	Phase	Standard	Weight	Box Qty	Unit	Trade NZ\$
1 Pole Base Only												
531049	Efen NH00 160A Base Only	Efen	Germany	33000-0050	160A	1		IEC 947-3	80g	3	Each	25.50
530735	Efen NH1 250A Base Only	Efen	Germany	33027-0010	250A	1		IEC 947-3	240g	3	Each	76.40
531006	Efen NH2 400A Base Only	Efen	Germany	33032-0010	400A	1		IEC 947-3	400g	3	Each	96.40
1 Pole (Single Phase)												
531022	Efen NH00 160A Switch	Efen	Germany	33107-0010	160A	1	Single	IEC 947-3	360g	1	Each	156.70
531030	Efen NH1 250A Switch	Efen	Germany	33095-0010	250A	1	Single	IEC 947-3	2.1kg	1	Each	399.60
530964	Efen NH2 400A Switch	Efen	Germany	33096-0010	400A	1	Single	IEC 947-3	2.1kg	1	Each	399.60
530972	Efen NH3 630A Switch	Efen	Germany	33097-0010	630A	1	Single	IEC 947-3	2.3kg	1	Each	427.50
Horizontal 3 Pole (Three Phase)												
530859	Efen NH00 100A Switch	Efen	Germany	34050-0000	100A	3	Three	IEC 947-3	500g	1	Each	176.90
530409	Efen NH00 160A Switch	Efen	Germany	34060-0000	160A	3	Three	IEC 947-3	600g	1	Each	182.40
531928	Efen NH1 250A Switch	Efen	Germany	34162-0000	250A	3	Three	IEC 947-3	2.1kg	1	Each	553.60
530743	Efen NH2 400A Switch	Efen	Germany	34262-0000	400A	3	Three	IEC 947-3	3.0kg	1	Each	745.80
530727	Efen NH3 630A Switch	Efen	Germany	34362-0000	630A	3	Three	IEC 947-3	4.0kg	1	Each	979.50



NH00 3P3P

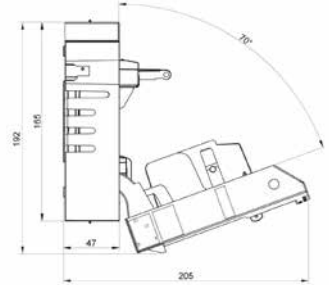
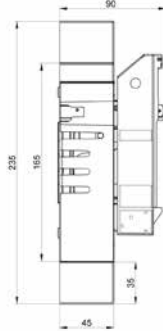

NH00 3P3P Dimensions

BUSSMANN DIN FUSE DISCONNECTS

Part Number	Description	Brand	Origin	CB Code	Amps	Poles	Phase	Standard	Box Qty	Unit	Trade NZ\$
1 Pole Base Only											
697001	Bussmann NH00 160A Base Only	Bussmann	Czech	SD00-D	160A	1	Single	IEC 60269	3	Each	14.70
697028	Bussmann NH1 250A Base Only	Bussmann	Czech	SD1-D	250A	1	Single	IEC 60269	3	Each	38.30
697036	Bussmann NH2 400A Base Only	Bussmann	Czech	SD2-D	400A	1	Single	IEC 60269	3	Each	43.10
1 Pole (Single Phase)											
697044	Bussmann NH00 160A Switch	Bussmann	Czech	BFH00-1A/F	160A	1	Single	IEC 60947-1	1	Each	134.70
697052	Bussmann NH1 250A Switch	Bussmann	Czech	BFH1-1A/F	250A	1	Single	IEC 60947-1	1	Each	316.20
697060	Bussmann NH2 400A Switch	Bussmann	Czech	BFH2-1A/F	400A	1	Single	IEC 60947-1	1	Each	316.20
Horizontal 3 Pole (Three Phase)											
697079	Bussmann NH00 160A Switch	Bussmann	Czech	BFH00-3A/F	160A	3	Three	IEC 60947-1	1	Each	135.80
697087	Bussmann NH1 250A Switch	Bussmann	Czech	BFH1-3A/F	250A	3	Three	IEC 60947-1	1	Each	318.00
697095	Bussmann NH2 400A Switch	Bussmann	Czech	BFH2-3A/F	400A	3	Three	IEC 60947-1	1	Each	447.60
697109	Bussmann NH3 630A Switch	Bussmann	Czech	BFH3-3A/F	630A	3	Three	IEC 60947-1	1	Each	592.70



HDG Steel

Stainless Steel

HD12A Tag

HDG Coupler

Stainless Coupler

AVON HDG & STAINLESS STEEL EARTHING RODS

Part Number	Description	Brand	Origin	Length	Diameter	Construction	Weight	Pack Qty	Unit	Trade NZ\$
16mm HDG Pointed Steel Earth Rods										
537071	Avon AA24005 16mm HDG Earth Rod (no tab)	Avon	NZ	2.0m	16mm	HDG Steel	3.3kg	10	Each	38.60
537098	Avon AA24009 16mm HDG Earth Rod (with HD12A Tab)	Avon	NZ	2.0m	16mm	HDG Steel	3.3kg	10	Each	46.00
Coupler for Avon HDG Earth Rods										
537101	Avon AA24024 16mm HDG Earth Rod Coupler	Avon	NZ	110mm	16mm	HDG Steel	200g	10	Each	57.30
12mm Stainless Steel Tapered Earth Rod										
537128	Avon AA24021 12mm Stainless Earth Rod (no tab)	Avon	NZ	1.5m	12mm	316 Stainless	1.4kg	10	Each	120.50
Coupler for Avon Stainless Earth Rod										
537136	Avon AA24015 12mm Stainless Earth Rod Coupler	Avon	NZ	85mm	12mm	316 Stainless	50g	10	Each	55.90



12mm 1800mm 500micron Copper-Clad Earth Rod (to AS1572)



BC12 Brass Coupler

TPS12 Star Point

REB1210-70

REC35-120

REX16-120

DHT12 Driving Head

Good Earth

10/Tube

FULTON 13MM EARTH RODS, ACCESSORIES & COMPOUND

Part Number	Description	Brand	Origin	Diameter	Length	Detail	Weight	Pack Qty	Unit	Trade NZ\$
12mm Copper-Clad Earth Rod										
523097	Fulton CDR-12-1800 Earth Rod 500micron Copper-Clad to AS1572	Fulton	Australia	12mm	1800mm	Steel to AS3679	2.0kg	10	Each	32.50
Accessories for 12mm Earth Rods										
523100	Fulton BC12 Brass Coupler for 12mm	Fulton	Australia	Fit 12mm	70mm		70g	20	Each	20.30
523119	Fulton TPS12 Star Point	Fulton	Australia	Fit 12mm	72mm		100g	20	Each	32.70
523070	Fulton REB1210-70 Clamp	Fulton	Australia	Fit 12mm	40mm	Cable Range 10-70mm ²	100g	20	Each	31.10
523089	Fulton REC35-120 Clamp	Fulton	Australia	Fit 12mm	67mm	Cable Range 35-120mm ²	150g	10	Each	26.60
523844	Fulton REX16-120 Clamp	Fulton	Australia	Fit 12mm	64mm	Cable Range 16-120mm ²	260g	10	Each	62.60
523461	Fulton DHT12 Driving Head Tool	Fulton	Australia	Fit 12mm	102mm		300g	5	Each	38.30
523488	Fulton 900 Kango Driving Moil	Fulton	Australia	Fit 12mm	227mm		570g	1	Each	701.40
Earthing Compound										
523704	Fulton Good Earth	Fulton	Australia			Covers 0.03m ³	15kg	1	Bag	90.40

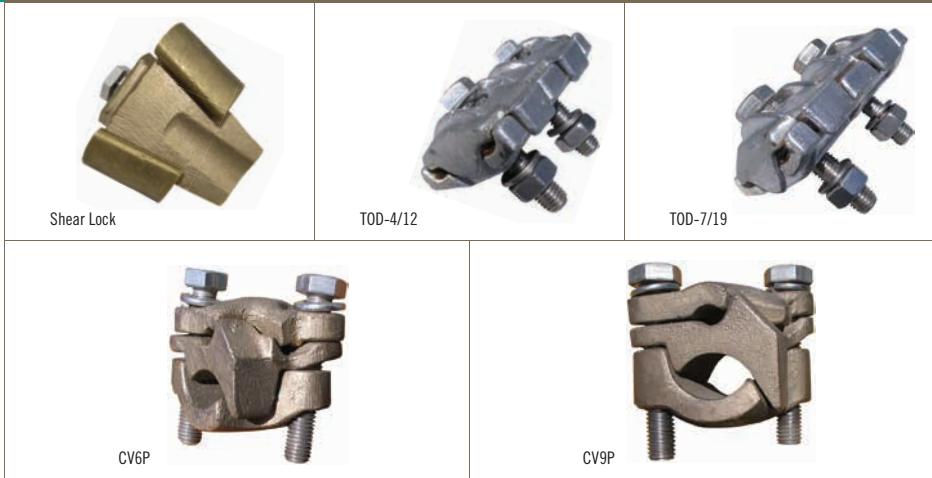

ASSORTED FULTON CLAMPS & CONNECTORS

Part Number	Description	Brand	Origin	Construction	Bolts	Conductor	Length	Weight	Box Qty	Unit	Trade NZ\$
Shear Lock Wedge Clamp											
524107	Fulton ECW-1 Shear Lock Clamp	Fulton	Australia	Gunmetal ETP	304 Stainless	25-70mm ²	56mm	950g	25	Each	71.30
Tee-Off Connectors											
524018	Fulton TOD-4/12 Single Bolted Tee-Off	Fulton	Australia	Aluminium	304 Stainless	4-12mm dia	51mm	200g	50	Each	30.60
523453	Fulton TOD-7/19 Single Bolted Tee-Off	Fulton	Australia	Aluminium	304 Stainless	7-19mm dia	70mm	237g	50	Each	31.70
523003	Fulton TOD-4/12 Double Bolted Tee-Off	Fulton	Australia	Aluminium	304 Stainless	4-12mm dia	70mm	400g	50	Each	41.70
523011	Fulton TOD-7/19 Double Bolted Tee-Off	Fulton	Australia	Aluminium	304 Stainless	7-19mm dia	95mm	475g	30	Each	46.20
523720	Fulton TOD-7/19 Triple Bolted Tee-Off	Fulton	Australia	Aluminium	304 Stainless	7-19mm dia	143mm	800g	10	Each	66.00
3-Piece Rising Main Connectors											
524026	Fulton CV3P Rising Main Connector	Fulton	Australia	Gunmetal ETP	316 Stainless	50-95mm ²	58mm	425g	15	Each	79.10
524034	Fulton CV4P Rising Main Connector	Fulton	Australia	Gunmetal ETP	316 Stainless	120-240mm ²	58mm	425g	15	Each	93.50
524042	Fulton CV5P Rising Main Connector	Fulton	Australia	Gunmetal ETP	316 Stainless	120-300mm ²	58mm	610g	15	Each	100.70
524050	Fulton CV6P Rising Main Connector	Fulton	Australia	Gunmetal ETP	316 Stainless	120-240mm ²	70mm	885g	15	Each	115.10
523747	Fulton CV8P Rising Main Connector	Fulton	Australia	Gunmetal ETP	316 Stainless	300-800mm ²	77mm	950g	15	Each	122.20
524069	Fulton CV9P Rising Main Connector	Fulton	Australia	Gunmetal ETP	316 Stainless	240-500mm ²	86mm	1.4kg	15	Each	143.90





Solid Link



NH000



NH00

SOLID LINK, NH000 & NH00 DIN FUSES (CLASS gG)

Part Number	Description	Brand	Origin	Amps	Volts	Break	Configuration	Box Qty	Unit	Trade NZ\$
Solid Link Blades										
688983	160A Solid Link 00 (SL00)	Bussmann	India	160A	500V	120kA	Solid Link	3	Each	18.20
657115	250A Solid Link 1 (SL1)	Bussmann	India	250A	500V	120kA	Solid Link	3	Each	22.80
689300	400A Solid Link 2 (SL2)	Bussmann	India	400A	500V	120kA	Solid Link	3	Each	27.60
657131	630A Solid Link 3 (SL3)	Bussmann	India	630A	500V	120kA	Solid Link	3	Each	53.10
NH000 DIN HRC Fuselinks										
688584	10A NH000 (10NHG000B)	Bussmann	India	10A	500V	120kA	DIN Blade	3	Each	8.00
690317	16A NH000 (16NHG000B)	Bussmann	India	16A	500V	120kA	DIN Blade	3	Each	8.00
689130	20A NH000 (20NHG000B)	Bussmann	India	20A	500V	120kA	DIN Blade	3	Each	8.00
689149	32A NH000 (32NHG000B)	Bussmann	India	32A	500V	120kA	DIN Blade	3	Each	8.00
689238	40A NH000 (40NHG000B)	Bussmann	India	40A	500V	120kA	DIN Blade	3	Each	8.00
689165	50A NH000 (50NHG000B)	Bussmann	India	50A	500V	120kA	DIN Blade	3	Each	8.00
689173	63A NH000 (63NHG000B)	Bussmann	India	63A	500V	120kA	DIN Blade	3	Each	8.00
689181	80A NH000 (80NHG000B)	Bussmann	India	80A	500V	120kA	DIN Blade	3	Each	8.00
689203	100A NH000 (100NHG000B)	Bussmann	India	100A	500V	120kA	DIN Blade	3	Each	8.00
NH00 DIN HRC Fuselinks										
689211	125A NH00 (125NHG000B)	Bussmann	India	125A	500V	120kA	DIN Blade	3	Each	11.70
689491	160A NH00 (160NHG000B)	Bussmann	India	160A	500V	120kA	DIN Blade	3	Each	11.70

COOPER BUSSMANN HRC DIN Blade FUSELINKS



NHO



NH1

NHO & NH1 DIN FUSES (CLASS gG)

Part Number	Description	Brand	Origin	Amps	Volts	Break	Configuration	Box Qty	Unit	Trade NZ\$
NHO DIN HRC Fuselinks										
665290	10A NHO (16NHG0B)	Bussmann	India	10A	500V	120kA	Blade Type	3	Each	13.90
689378	16A NHO (16NHG0B)	Bussmann	India	16A	500V	120kA	Blade Type	3	Each	13.90
689831	20A NHO (20NHG0B)	Bussmann	India	20A	500V	120kA	Blade Type	3	Each	13.90
688576	25A NHO (25NHG0B)	Bussmann	India	25A	500V	120kA	Blade Type	3	Each	13.90
693162	32A NHO (32NHG0B)	Bussmann	India	32A	500V	120kA	Blade Type	3	Each	13.90
689963	40A NHO (40NHG0B)	Bussmann	India	40A	500V	120kA	Blade Type	3	Each	13.90
689858	50A NHO (50NHG0B)	Bussmann	India	50A	500V	120kA	Blade Type	3	Each	13.90
689319	63A NHO (63NHG0B)	Bussmann	India	63A	500V	120kA	Blade Type	3	Each	13.90
689335	100A NHO (100NHG0B)	Bussmann	India	100A	500V	120kA	Blade Type	3	Each	13.90
689343	125A NHO (125NHG0B)	Bussmann	India	125A	500V	120kA	Blade Type	3	Each	15.90
689351	160A NHO (160NHG0B)	Bussmann	India	160A	500V	120kA	Blade Type	3	Each	15.90
NH1 DIN HRC Fuselinks										
689866	16A NH1 (16NHG01B)	Bussmann	India	16A	500V	120kA	Blade Type	3	Each	14.40
689688	20A NH1 (20NHG01B)	Bussmann	India	20A	500V	120kA	Blade Type	3	Each	14.40
689432	25A NH1 (25NHG01B)	Bussmann	India	25A	500V	120kA	Blade Type	3	Each	14.40
692530	32A NH1 (32NHG01B)	Bussmann	India	32A	500V	120kA	Blade Type	3	Each	14.40
686700	40A NH1 (40NHG01B)	Bussmann	India	40A	500V	120kA	Blade Type	3	Each	14.40
689416	50A NH1 (50NHG01B)	Bussmann	India	50A	500V	120kA	Blade Type	3	Each	14.40
689424	63A NH1 (63NHG01B)	Bussmann	India	63A	500V	120kA	Blade Type	3	Each	14.40
689084	80A NH1 (80NHG01B)	Bussmann	India	80A	500V	120kA	Blade Type	3	Each	14.40
689440	100A NH1 (100NHG01B)	Bussmann	India	100A	500V	120kA	Blade Type	3	Each	14.40
689459	125A NH1 (125NHG01B)	Bussmann	India	125A	500V	120kA	Blade Type	3	Each	14.40
689467	160A NH1 (160NHG01B)	Bussmann	India	160A	500V	120kA	Blade Type	3	Each	17.00
689475	200A NH1 (200NHG1B)	Bussmann	India	200A	500V	120kA	Blade Type	3	Each	17.00
661066	224A NH1 (224NHG1B)	Bussmann	India	224A	500V	120kA	Blade Type	3	Each	17.00
689939	250A NH1 (250NHG1B)	Bussmann	India	250A	500V	120kA	Blade Type	3	Each	17.00



NH2



NH3

NH2 & NH3 DIN FUSES (CLASS gG)

Part Number	Description	Brand	Origin	Amps	Volts	Break	Configuration	Box Qty	Unit	Trade NZ\$
NH2 DIN HRC Fuselinks										
686735	50A NH2 (50NHG02B)	Bussmann	India	50A	500V	120kA	Blade Type	3	Each	18.50
689548	63A NH2 (63NHG02B)	Bussmann	India	63A	500V	120kA	Blade Type	3	Each	18.50
689998	80A NH2 (80NHG02B)	Bussmann	India	80A	500V	120kA	Blade Type	3	Each	18.50
689882	100A NH2 (100NHG02B)	Bussmann	India	100A	500V	120kA	Blade Type	3	Each	18.50
689564	125A NH2 (125NHG02B)	Bussmann	India	125A	500V	120kA	Blade Type	3	Each	18.50
689572	160A NH2 (160NHG02B)	Bussmann	India	160A	500V	120kA	Blade Type	3	Each	18.50
689580	200A NH2 (200NHG02B)	Bussmann	India	200A	500V	120kA	Blade Type	3	Each	18.50
685860	224A NH2 (224NHG02B)	Bussmann	India	224A	500V	120kA	Blade Type	3	Each	18.50
689890	250A NH2 (250NHG02B)	Bussmann	India	250A	500V	120kA	Blade Type	3	Each	18.50
689610	315A NH2 (315NHG2B)	Bussmann	India	315A	500V	120kA	Blade Type	3	Each	25.00
689629	355A NH2 (355NHG2B)	Bussmann	India	355A	500V	120kA	Blade Type	3	Each	27.20
689637	400A NH2 (400NHG2B)	Bussmann	India	400A	500V	120kA	Blade Type	3	Each	27.20
NH3 DIN HRC Fuselinks										
689645	315A NH3 (315NHG03B)	Bussmann	India	315A	500V	120kA	Blade Type	3	Each	32.40
689556	355A NH3 (355NHG03B)	Bussmann	India	355A	500V	120kA	Blade Type	3	Each	32.40
689599	400A NH3 (400NHG03B)	Bussmann	India	400A	500V	120kA	Blade Type	3	Each	33.20
689696	500A NH3 (500NHG3B)	Bussmann	India	500A	500V	120kA	Blade Type	3	Each	46.50
689718	630A NH3 (630NHG3B)	Bussmann	India	630A	500V	120kA	Blade Type	3	Each	47.50



C10G32 10x38

CYLINDRICAL 10X38 FUSELINKS (CLASS gG)

Part Number	Description	Brand	Origin	Amps	Volts	Break	Configuration	Box Qty	Unit	Trade NZ\$
Cylindrical 10x38 HRC Fuselinks (IEC 60269)										
654574	1A 10x38 Fuse (C10G1)	Bussmann	India	1A	500V	120kA	10x38mm Cylinder	10	Each	2.50
654299	2A 10x38 Fuse (C10G2)	Bussmann	India	2A	500V	120kA	10x38mm Cylinder	10	Each	2.50
654388	4A 10x38 Fuse (C10G4)	Bussmann	India	4A	500V	120kA	10x38mm Cylinder	10	Each	2.50
654302	6A 10x38 Fuse (C10G6)	Bussmann	India	6A	500V	120kA	10x38mm Cylinder	10	Each	2.50
654310	10A 10x38 Fuse (C10G10)	Bussmann	India	10A	500V	120kA	10x38mm Cylinder	10	Each	2.50
654329	16A 10x38 Fuse (C10G16)	Bussmann	India	16A	500V	120kA	10x38mm Cylinder	10	Each	2.50
654337	20A 10x38 Fuse (C10G20)	Bussmann	India	20A	500V	120kA	10x38mm Cylinder	10	Each	2.50
654353	25A 10x38 Fuse (C10G25)	Bussmann	India	25A	500V	120kA	10x38mm Cylinder	10	Each	2.50
654345	32A 10x38 Fuse (C10G32)	Bussmann	India	32A	500V	120kA	10x38mm Cylinder	10	Each	2.50
Fuseholder for 10x38 Fuses (IEC 60269/60947)										
666858	CHMID Fuseholder	Bussmann	China	32A	690V	120kA	10x38mm Cylinder	12	Each	11.20

COOPER BUSSMANN HRC 240V High Speed FUSES



6LCT



20LCT



35LET



100LET



200LMT



450LMT

BS88 'T' TYPE HIGH-SPEED SEMI-CONDUCTOR FUSELINKS

Part Number	Description	Brand	Origin	Amps	Volts AC	Volts DC	Fixing Centre	A2T	Box Qty	Unit	Trade NZ\$
LCT High Speed Fuses											
684848	6LCT	Bussmann	India	6A	240V	150V	38mm	9	20	Each	15.40
684856	10LCT	Bussmann	India	10A	240V	150V	38mm	22	20	Each	15.40
684880	12LCT	Bussmann	India	12A	240V	150V	38mm	32	20	Each	15.40
684864	16LCT	Bussmann	India	16A	240V	150V	38mm	100	20	Each	15.40
684872	20LCT	Bussmann	India	20A	240V	150V	38mm	160	20	Each	15.40
LET High Speed Fuses											
685003	25LET	Bussmann	India	25A	240V	150V	42mm	250	10	Each	39.80
685011	32LET	Bussmann	India	32A	240V	150V	42mm	450	10	Each	39.80
685038	35LET	Bussmann	India	35A	240V	150V	42mm	600	10	Each	39.80
684937	50LET	Bussmann	India	50A	240V	150V	42mm	1400	10	Each	39.80
685046	63LET	Bussmann	India	63A	240V	150V	42mm	2200	10	Each	39.80
685054	80LET	Bussmann	India	80A	240V	150V	42mm	3800	10	Each	39.80
685062	100LET	Bussmann	India	100A	240V	150V	42mm	7500	10	Each	39.80
685070	125LET	Bussmann	India	125A	240V	150V	42mm	7500	10	Each	39.80
685089	160LET	Bussmann	India	160A	240V	150V	42mm	16000	10	Each	39.80
685097	180LET	Bussmann	India	180A	240V	150V	42mm	29000	10	Each	39.80
LMT High Speed Fuses											
685275	160LMT	Bussmann	India	160A	240V	150V	59mm	16000	1	Each	82.80
685283	200LMT	Bussmann	India	200A	240V	150V	59mm	20000	1	Each	82.80
685291	250LMT	Bussmann	India	250A	240V	150V	59mm	40000	1	Each	82.80
685305	315LMT	Bussmann	India	315A	240V	150V	59mm	75000	1	Each	88.00
685313	355LMT	Bussmann	India	355A	240V	150V	59mm	100000	1	Each	88.00
685321	400LMT	Bussmann	India	400A	240V	150V	59mm	160000	1	Each	96.00
685348	450LMT	Bussmann	India	450A	240V	150V	59mm	220000	1	Each	105.70

COOPER BUSSMANN HRC 690V High Speed FUSES



BS88 'T' TYPE HIGH-SPEED SEMI-CONDUCTOR FUSELINKS

Part Number	Description	Brand	Origin	Amps	Volts AC	Volts DC	Fixing Centre	A2T	Box Qty	Unit	Trade NZ\$
CT High Speed Fuses											
690686	6CT	Bussmann	India	6A	690V	500V	64mm	12	20	Each	18.20
690694	10CT	Bussmann	India	10A	690V	500V	64mm	48	20	Each	18.20
690708	12CT	Bussmann	India	12A	690V	500V	64mm	65	20	Each	18.20
690716	16CT	Bussmann	India	16A	690V	500V	64mm	110	20	Each	18.20
690724	20CT	Bussmann	India	20A	690V	500V	64mm	220	20	Each	18.20
FE High Speed Fuses											
690791	35FE	Bussmann	India	35A	690V	500V	64mm	200	20	Each	41.60
690805	40FE	Bussmann	India	40A	690V	500V	64mm	200	20	Each	41.60
690813	45FE	Bussmann	India	45A	690V	500V	64mm	200	20	Each	41.60
690821	50FE	Bussmann	India	50A	690V	500V	64mm	200	20	Each	41.60
690848	63FE	Bussmann	India	63A	690V	500V	64mm	200	20	Each	41.60
FEE High Speed Fuses											
690899	100FEE	Bussmann	India	100A	690V	500V	70mm	2400	5	Each	84.90
690902	120FEE	Bussmann	India	120A	690V	500V	70mm	3100	5	Each	84.90
684503	140FEE	Bussmann	India	140A	690V	500V	70mm	3800	5	Each	88.90
690910	160FEE	Bussmann	India	160A	690V	500V	70mm	5700	5	Each	93.60
691003	200FEE	Bussmann	India	200A	690V	500V	70mm	11400	5	Each	102.50
FM High Speed Fuses											
690937	180FM	Bussmann	India	180A	690V	500V	85mm	13500	1	Each	102.50
690945	200FM	Bussmann	India	200A	690V	500V	85mm	18500	1	Each	99.00
691801	225FM	Bussmann	India	225A	690V	500V	85mm	26500	1	Each	99.00
690953	250FM	Bussmann	India	250A	690V	500V	85mm	37500	1	Each	106.50
690961	280FM	Bussmann	India	280A	690V	500V	85mm	55000	1	Each	112.50
690988	315FM	Bussmann	India	315A	690V	500V	85mm	77000	1	Each	124.50



76mm Centre



300-1 Carrier for 76mm



82mm Centre

76 & 82MM J-TYPE FUSELINKS & CARRIERS

Part Number	Description	Brand	Origin	Amps	Volts	Fixing Centre	Standard	Box Qty	Unit	Trade NZ\$
76mm Centre J-Type Fuselinks										
647233	63A 76mm (63MJ29-6)	Bussmann	India	63A	415V	76mm	IEC 60269-1	5	Each	27.20
647268	100A 76mm (100MJ29-6)	Bussmann	India	100A	415V	76mm	IEC 60269-1	5	Each	27.20
647276	125A 76mm (125MJ29-6)	Bussmann	India	125A	415V	76mm	IEC 60269-1	5	Each	27.20
647284	160A 76mm (160MJ29-6)	Bussmann	India	160A	415V	76mm	IEC 60269-1	5	Each	27.20
647292	200A 76mm (200MJ29-6)	Bussmann	India	200A	415V	76mm	IEC 60269-1	5	Each	27.20
647306	250A 76mm (250MJ29-6)	Bussmann	India	250A	415V	76mm	IEC 60269-1	5	Each	27.20

Part Number	Description	Brand	Origin	Amps	Colour	Construction	Standard	Weight	Box Qty	Unit	Trade NZ\$
Carriers for J-Type 76mm Fuses											
468622	NZI 300-1 Shrouded Carrier	NZI	NZ	200A	White	Porcelain & ETPNFM	AS/NZS 3947	600g	1	Each	99.50
470732*	NZI 300-8 Base Only	NZI	NZ	200A	White	Formica & ETPNFM	AS/NZS 3947	700g	1	Each	162.50

Part Number	Description	Brand	Origin	Amps	Volts	Fixing Centre	Standard	Box Qty	Unit	Trade NZ\$
82mm Centre J-Type Fuselinks										
647373	32A 82mm (32MJ30-8)	Bussmann	India	32A	415V	82mm	IEC 60269-1	5	Each	28.50
647381	40A 82mm (40MJ30-8)	Bussmann	India	40A	415V	82mm	IEC 60269-1	5	Each	28.50
647403	63A 82mm (63MJ30-8)	Bussmann	India	63A	415V	82mm	IEC 60269-1	5	Each	28.50
647411	80A 82mm (80MJ30-7)	Bussmann	India	80A	415V	82mm	IEC 60269-1	5	Each	28.50
647438	100A 82mm (100MJ30-7)	Bussmann	India	100A	415V	82mm	IEC 60269-1	5	Each	28.50
647446	125A 82mm (125MJ30-7)	Bussmann	India	125A	415V	82mm	IEC 60269-1	5	Each	28.50
647454	160A 82mm (160MJ30-7)	Bussmann	India	160A	415V	82mm	IEC 60269-1	5	Each	28.50
647462	200A 82mm (200MJ30-7)	Bussmann	India	200A	415V	82mm	IEC 60269-1	5	Each	28.50
647470	250A 82mm (250MJ30-7)	Bussmann	India	250A	415V	82mm	IEC 60269-1	5	Each	28.50
647489	315A 82mm (315MJ30-7)	Bussmann	India	315A	415V	82mm	IEC 60269-1	5	Each	28.50
647659	355A 82mm (355PJ30-7)	Bussmann	India	355A	415V	82mm	IEC 60269-1	5	Each	43.70
647667	400A 82mm (400PJ30-7)	Bussmann	India	400A	415V	82mm	IEC 60269-1	5	Each	43.70

* Limited stock available.

82 & 92MM J-TYPE FUSELINKS & CARRIERS

Part Number	Description	Brand	Origin	Amps	Colour	Construction	Standard	Weight	Box Qty	Unit	Trade NZ\$
Carriers for J-Type 82mm Fuses											
468592	NZI 325-5 Unshrouded Carrier	NZI	NZ	400A	Grey	Porcelain & ETPNFM	AS/NZS 3947	900g	1	Each	107.20
468614	NZI 325-7 Shrouded Carrier	NZI	NZ	400A	White	Porcelain & ETPNFM	AS/NZS 3947	1.1kg	1	Each	121.20
469726	NZI 325 Slotted Shorting Link	NZI	NZ	400A		Copper ETP	AS/NZS 3947	110g	1	Each	20.70
469858*	NZI 325-8 Base Only	NZI	NZ	400A		Formica & ETPNFM	AS/NZS 3947	1.2kg	1	Each	143.30

Part Number	Description	Brand	Origin	Amps	Volts	Fixing Centre	Standard	Weight	Box Qty	Unit	Trade NZ\$
92mm Centre J-Type Fuselinks											
658650	32A 92mm (32MJ31-8)	Bussmann	India	33A	415V	92mm	IEC 60269-1		5	Each	34.70
647535	40A 92mm (40MJ31-8)	Bussmann	India	40A	415V	92mm	IEC 60269-1		5	Each	34.70
647543	63A 92mm (63MJ31-8)	Bussmann	India	63A	415V	92mm	IEC 60269-1		5	Each	34.70
647551	80A 92mm (80MJ31-7)	Bussmann	India	80A	415V	92mm	IEC 60269-1		5	Each	34.70
647578	100A 92mm (100MJ31-7)	Bussmann	India	100A	415V	92mm	IEC 60269-1		5	Each	34.70
647586	125A 92mm (125MJ31-7)	Bussmann	India	125A	415V	92mm	IEC 60269-1		5	Each	34.70
647594	160A 92mm (160MJ31-7)	Bussmann	India	160A	415V	92mm	IEC 60269-1		5	Each	34.70
647608	200A 92mm (200MJ31-7)	Bussmann	India	200A	415V	92mm	IEC 60269-1		5	Each	34.70
647616	250A 92mm (250MJ31-7)	Bussmann	India	250A	415V	92mm	IEC 60269-1		5	Each	34.70
647624	315A 92mm (315MJ31-7)	Bussmann	India	315A	415V	92mm	IEC 60269-1		5	Each	34.70
647675	355A 92mm (355PJ31-7)	Bussmann	India	355A	415V	92mm	IEC 60269-1		5	Each	38.00
647683	400A 92mm (400PJ31-7)	Bussmann	India	400A	415V	92mm	IEC 60269-1		5	Each	38.00
658782	450A 92mm (450RJ31-7)	Bussmann	India	450A	415V	92mm	IEC 60269-1		5	Each	46.20
647756	500A 92mm (500RJ31-7)	Bussmann	India	500A	415V	92mm	IEC 60269-1		5	Each	46.20
658804	560A 92mm (560SJ31-6)	Bussmann	India	560A	415V	92mm	IEC 60269-1		5	Each	55.00
647772	630A 92mm (630SJ31-6)	Bussmann	India	630A	415V	92mm	IEC 60269-1		5	Each	64.90
Carrier for J-Type 92mm Fuses											
471011	NZI 3625-7 Shrouded Carrier	NZI	NZ	600A	White	Porcelain & ETPNFM	AS/NZS 3947	1.5kg	1	Each	131.40

* Limited stock available.





NEOZED (DO) & DIAZED (ND) FUSELINKS (CLASS GG) TO AS/NZS 60269

Part Number	Description	Brand	Origin	Amps	Volts	Length	Width	Nib Diameter	Box Qty	Unit	Trade
Neozed D01 Bottle Fuses											
687855	2NZ01	Bussmann	India	2A	440V	36mm	11mm		10	Each	2.80
687863	4NZ01	Bussmann	India	4A	440V	36mm	11mm		10	Each	2.80
687820	6NZ01	Bussmann	India	6A	440V	36mm	11mm		10	Each	2.80
687839	10NZ01	Bussmann	India	10A	440V	36mm	11mm		10	Each	2.80
687847	16NZ01	Bussmann	India	16A	440V	36mm	11mm		10	Each	2.80
Neozed D02 Bottle Fuses											
687901	20NZ02	Bussmann	India	20A	440V	36mm	15mm		10	Each	3.90
687928	25NZ02	Bussmann	India	25A	440V	36mm	15mm		10	Each	3.90
687936	35NZ02	Bussmann	India	35A	440V	36mm	15mm		10	Each	3.90
687944	50NZ02	Bussmann	India	50A	440V	36mm	15mm		10	Each	3.90
687952	63NZ02	Bussmann	India	63A	440V	36mm	15mm		10	Each	3.90
Diazied D16 Bottle Fuses											
690597	2D16	Bussmann	India	2A	500V	50mm	13.2mm	6mm	5	Each	2.30
690600	4D16	Bussmann	India	4A	500V	50mm	13.2mm	6mm	5	Each	2.30
690619	6D16	Bussmann	India	6A	500V	50mm	13.2mm	6mm	5	Each	2.30
690627	10D16	Bussmann	India	10A	500V	50mm	13.2mm	8mm	5	Each	2.30
690635	16D16	Bussmann	India	16A	500V	50mm	13.2mm	10mm	5	Each	2.30
690643	20D16	Bussmann	India	20A	500V	50mm	13.2mm	12mm	5	Each	2.30
690651	25D16	Bussmann	India	25A	500V	50mm	13.2mm	14mm	5	Each	2.30
Diazied D27 Bottle Fuses											
688657	2D27	Bussmann	India	2A	500V	50mm	21.5mm	6mm	5	Each	2.00
688665	4D27	Bussmann	India	4A	500V	50mm	21.5mm	6mm	5	Each	2.00
688673	6D27	Bussmann	India	6A	500V	50mm	21.5mm	6mm	5	Each	2.00
688681	10D27	Bussmann	India	10A	500V	50mm	21.5mm	8mm	5	Each	2.00
688703	16D27	Bussmann	India	16A	500V	50mm	21.5mm	10mm	5	Each	2.00
688711	20D27	Bussmann	India	20A	500V	50mm	21.5mm	12mm	5	Each	2.00
688738	25D27	Bussmann	India	25A	500V	50mm	21.5mm	14mm	5	Each	2.00

COOPER BUSSMANN 12kV HRC FUSELINKS



SELECTED OIL & FULL RANGE MV FUSELINKS

Part Number	Description	Brand	Origin	Amps	Volts	Break	Dimensions	Configuration	Box Qty	Unit	Trade NZ\$
12kV Fuses – Oil											
670251	6.3A Oil (120EFMA6.3)	Bussmann	India	6.3A	12kV	40kA	254Lx63.5Dmm	Ferrule	3	Each	232.90
670243	10A Oil (120EFMA10)	Bussmann	India	10A	12kV	40kA	254Lx63.5Dmm	Ferrule	3	Each	232.90
670278	16A Oil (120EFMA16)	Bussmann	India	16A	12kV	40kA	254Lx63.5Dmm	Ferrule	3	Each	232.90
670286	20A Oil (120EFMA20)	Bussmann	India	20A	12kV	40kA	254Lx63.5Dmm	Ferrule	3	Each	232.90
670065	25A Oil (120EFMA25)	Bussmann	India	25A	12kV	40kA	254Lx63.5Dmm	Ferrule	3	Each	232.90
670073	31.5A Oil (120EFMA31.5)	Bussmann	India	31.5A	12kV	40kA	254Lx63.5Dmm	Ferrule	3	Each	232.90
670081	40A Oil (120EFMA40)	Bussmann	India	40A	12kV	40kA	254Lx63.5Dmm	Ferrule	3	Each	232.90
670006	50A Oil (120EFMA50)	Bussmann	India	50A	12kV	40kA	254Lx63.5Dmm	Ferrule	3	Each	233.70
670014	63A Oil (120EFMA63)	Bussmann	India	63A	12kV	40kA	254Lx63.5Dmm	Ferrule	3	Each	236.10
670111	71A Oil (120HFMA71)	Bussmann	India	71A	12kV	40kA	254Lx63.5Dmm	Ferrule	3	Each	247.40
670138	80A Oil (120HFMA80)	Bussmann	India	80A	12kV	40kA	254Lx63.5Dmm	Ferrule	3	Each	247.40
12kV Fuses – Full Range											
670545	6.3A Full Range (12FDLSJ6.3)	Bussmann	UK	6.3A	12kV	50kA	292Lx51Dmm	Ferrule	3	Each	308.70
670553	10A Full Range (12FDLSJ10)	Bussmann	UK	10A	12kV	50kA	292Lx51Dmm	Ferrule	3	Each	308.70
670642	16A Full Range (12FDLSJ16)	Bussmann	UK	16A	12kV	50kA	292Lx51Dmm	Ferrule	3	Each	362.00
670502	20A Full Range (12FDLSJ20)	Bussmann	UK	20A	12kV	50kA	292Lx51Dmm	Ferrule	3	Each	362.00
671010	25A Full Range (12FDLSJ25)	Bussmann	UK	25A	12kV	50kA	292Lx51Dmm	Ferrule	3	Each	362.00
670499	31.5A Full Range (12FDLSJ31.5)	Bussmann	UK	31.5A	12kV	50kA	292Lx51Dmm	Ferrule	3	Each	410.30
670030	40A Full Range (12FFLSJ40)	Bussmann	UK	40A	12kV	50kA	292Lx76Dmm	Ferrule	3	Each	495.50
670510	50A Full Range (12FFLSJ50)	Bussmann	UK	50A	12kV	50kA	292Lx76Dmm	Ferrule	3	Each	555.20
670049	63A Full Range (12FFLSJ63)	Bussmann	UK	63A	12kV	50kA	292Lx76Dmm	Ferrule	3	Each	700.20
670057	80A Full Range (12FXLSJ80)	Bussmann	UK	80A	12kV	50kA	292Lx88Dmm	Ferrule	3	Each	896.00

Motor Circuit Protection Chart

AS 2005,BS88 and IEC 60269

AS NZS 60269

Power (KW)	Horse Power (HP)	Current F.L.C. (AMPS)	Direct On Line		Assisted Start Fuse
			Normal Fuse	Motor Fuse	
0.75	1.0	1.9	6	–	4
1.1	1.5	2.5	10	–	6
1.5	2.0	3.5	16	–	10
2.2	3.0	5.0	20	–	10
3.0	4.0	6.5	20	–	16
4.0	5.5	8.0	25	20M25 G06	16
5.5	7.5	11	32	20M32 G06	20
7.5	10	14	40	32M40 G06	20
11	15	21	50	32M50 H07	25
15	20	28	63	32M63 H07	40
18.5	25	35	80	63M80 K07	40
22	30	40	80	63M100 K07	50
30	40	55	100	63M100 K07	63
37	50	66	125	100M125 L09	80
45	60	80	160	100M160 L09	100
55	75	102	200	–	125
75	100	135	250	200M250 M09	160
90	120	165	250	200M250 M14	200
110	150	200	350	315M400 N09	200
132	180	230	355	–	250
150	200	260	400	–	315
160	220	280	400	–	315
185	250	325	450	400M500 P09	355
200	270	350	500	400M500 P11	400
220	300	385	560	–	450
250	340	450	560	–	450
315	430	545	670	–	560

D.O.L. based on 7 x motor F.L.C. for 10 seconds
Assisted start based on 3.5 x motor F.L.C. for 20 seconds

HRC Fuselinks COMPATIBILITY CHART

Certified to BS88 Parts 1 + 2 + 6 (G06 only), IEC 60269-1, Rated Breaking Capacity 80kA

NZI	Bussmann	BS88 Ref	Rating (amps)	Fixing Centres	Compatible With		
G06	NSD		2-20	Staggered	NS	SN2	FE01
G06			25-32	Staggered	NS	SN2	NS
NITD	NITD	A1	2-32	44.5mm	NIT	SA2	NIT
H07	AAO	A2	2-32	73.5mm	TIA	SB2	TIA
K07	BAO	A3	40-63	73mm	TIS	SB4	TIS
K07R	OSD		80-100	73mm			
AD/BD	AD		2-63	111mm	TBC	SF4	TBC
L09	CD	B1	80-100	111mm	TC	SF5	TC
M09	DD	B2	125-200	111mm	TF	SF6	TF
N09	ED	B3	250-315	111mm	TKF	SF7	TKF
L14	CEO		32-100	94mm	TCP	SD5	TCP
M14	DEO		125-200	94mm	TFP	SD6	TFP
N11	EFS		250	133mm	TKM	SG7	TKM
N11	EFS		315	133-184mm	TKM	SG7	TKM
P09	ED	B4	350-400	111mm	TMF	SF8	TMF
P11	EF	C1	350-400	133-184mm	TM	SH8	TM
P12			350-400	165-228mm	TMT	TMT8	TMT
R11	FF		450-630	133-184mm	TTM	SH9	TTM
R12	FG		450-630	165-228mm	TT	TT9	TT
S11	GF	C3	700-800	133-184mm	TLM	SH10	
S12	GG		700-800	165-228mm	TLT	TLT10	TLT
U44			1000-1250	149mm	TXU	SJ11	TXU



**NEW ZEALAND INSULATORS LIMITED**

Established 1924

NZI Customer Service

Phone +64-3-6878100, Fax 03-6158125

Office Hours 7.30am – 5.00pm (weekdays NZ Time)

Email sales@nzinsulators.co.nz

NZI Temuka Factory, HQ & South Island Warehouse

Thomas Street, PO Box 5, Temuka 7948

Phone +64-3-6878100

NZI Auckland Branch & North Island Warehouse

11 Wookey Lane, Kumeu 0810

Phone +64-9-4125941

NZI Brands NZI, Temuka Pottery, AX

Exclusive Distribution in NZ DTR, Payer, GIG, NGK Stanger, Fulton, Efen

Shared Distribution in NZ Avon, Cooper Bussmann, Red Spot

Websites nzinsulators.co.nz & temukapottery.co.nz

Timing

This catalogue was released on 16/12/13 and all product changes are effective from that date.

Freight & Order Size

There is no minimum order. All orders exceeding NZ\$1,000 excl GST are freight-free New Zealand wide. Orders under \$1,000 are warmly welcomed, but we ask for a freight cost contribution, as per the most recent NZI Freight Rate Card – which is posted & updated on the home page of nzinsulators.co.nz. We do ask that whenever possible, orders be made in full-box multiples.

Wholesalers

Wholesalers can buy direct from NZI at Trade Price less a discount.

The 2014 LV Pocket Book lists Trade Prices as they stood at 11/11/13.

The freight-free threshold for Wholesalers (buying off Trade Price) is NZ\$300 excl GST. Wholesalers who also operate a Network Store need two NZI accounts.

Terms of Trade

Transactions with New Zealand Insulators are made under overarching 'terms of trade' which can be downloaded from the home page of nzinsulators.co.nz.

Copyright

This catalogue, our coding, product images and the brands NZI, Temuka Pottery & AX are the intellectual property of New Zealand Insulators Limited.

Thank you for supporting NZI's Temuka factory.

To retain our vital (local) manufacturing capability, please specify New Zealand Insulators brand.



Bussmann
by E.T.N

EFEN ©



NEW ZEALAND INSULATORS



TEMUKA

NZI CUSTOMER SERVICES
7.30AM – 5.00PM WEEKDAYS
T 03-6878100
F 03-6158125
E sales@nzinsulators.co.nz

HQ & FACTORY
THOMAS STREET
PO BOX 5 TEMUKA 7948

AUCKLAND BRANCH
11 WOOKEY LANE
KUMEU 0810

W nzinsulators.co.nz

